

Modeling of a Control lever shaft using Inventor 2014

Author: Prof. univ. Dr. ing. **Constantin STANCESCU**
Universitatea **POLITEHNICA** din Bucuresti, Romania - March 2015

This tutorial consists of one lesson that will provide you with a basic understanding of modeling special parts, and introduce you to achieving advanced abilities in modeling parts.

Audience: Users accommodated with basic modeling in Inventor 2014

Prerequisites: Basic Autodesk Inventor 2014 knowledge

Time to complete: 20 minutes

Objectives

In this tutorial, you learn how to model a special part including the following:

- Creating multiple work planes for different sketches
- Obtaining the middle body of the part by using Intersection of volumes

Tutorial Files

No files necessary

Modeling the Control lever shaft

Part Analysis: The part is included in the steering sub assembly of some vehicles. It houses a roller which is engaged with the worm shaft connected to the steering wheel.

Multiple views of the middle body of part are presented in the image. The special construction consists of its spatial geometry.

The image with the entire part and its technical drawing follows.

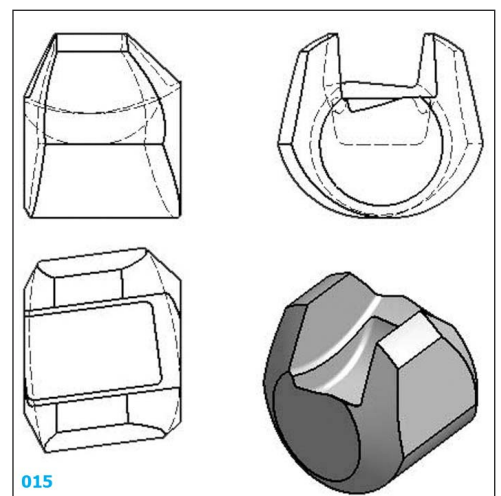

003. After taking visibility of [P1] and [P2] and the first sketch, a new sketch on [P3]

004. **Extrude** the new profile between [P1] and [P2] (selected from *browser*)

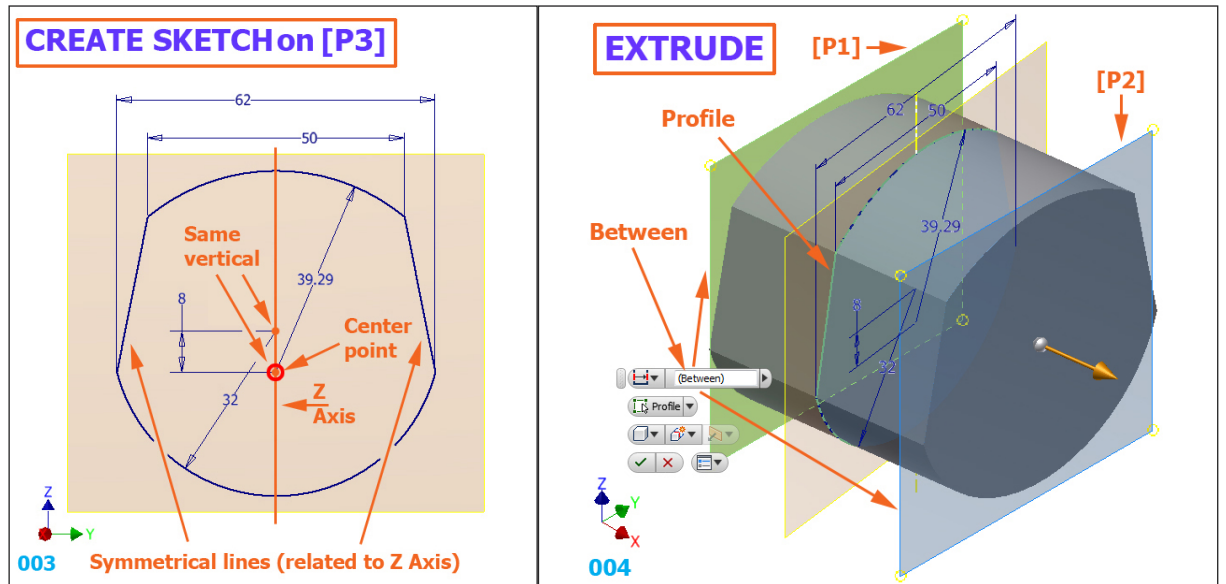

005. The result of extruding

006. New *work plane*: to create [P4] select successively 1 and 2, in order

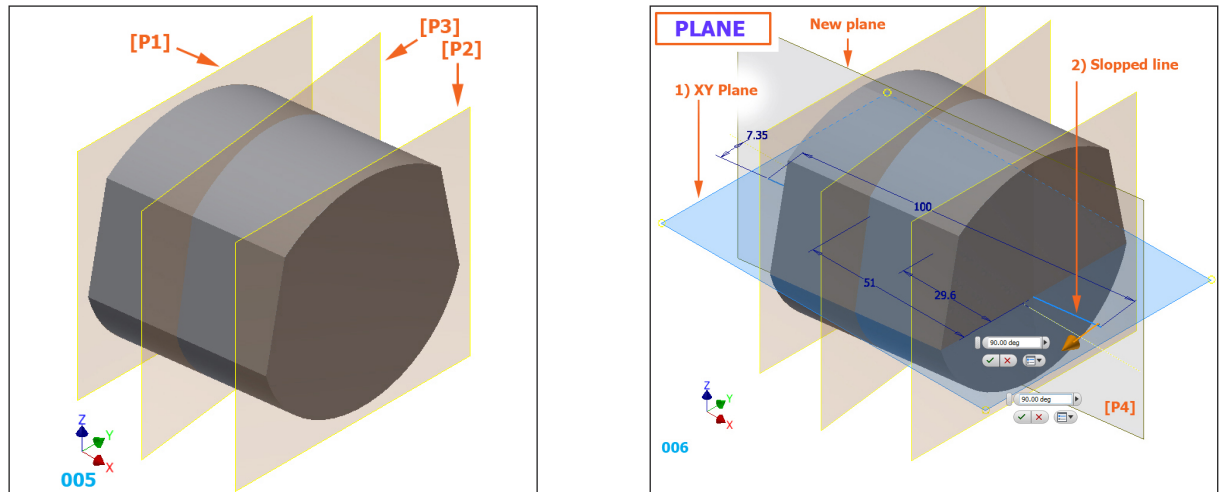

007. New sketch on [P4]: Circle with Radius=50 at 60 from *Center point* on the same vertical

008. **Extrude** the circle symmetrically on 31, option *Cut*

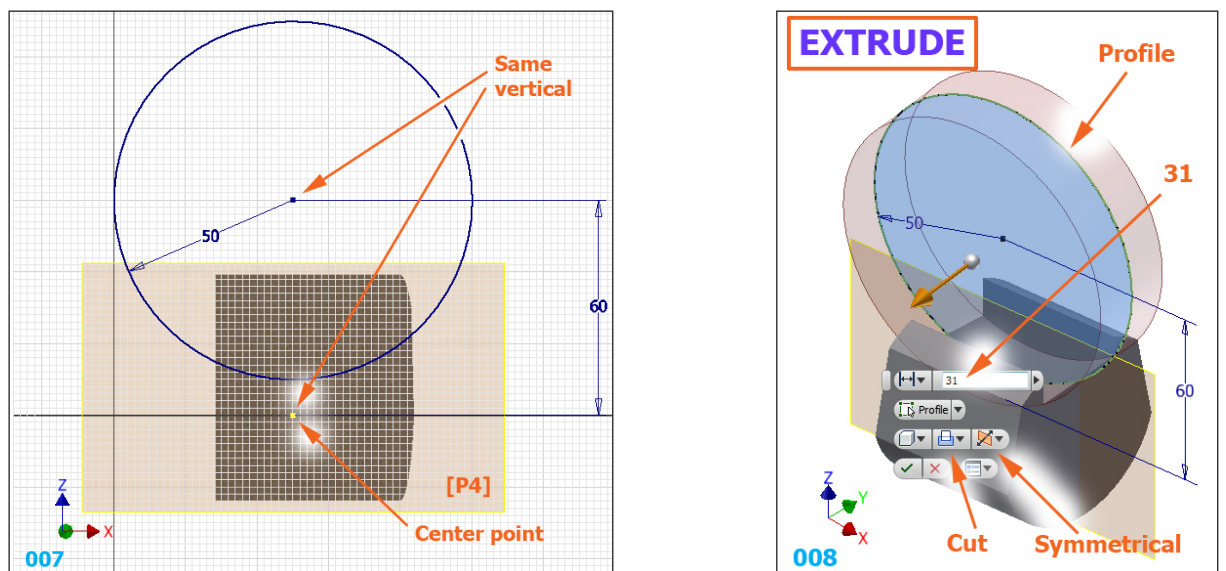

009. **Fillet** Radius 2 on the indicated edges

010. New sketch on [P4]: two semicircles at 3 (the inferior tangent centered on *Center point*)

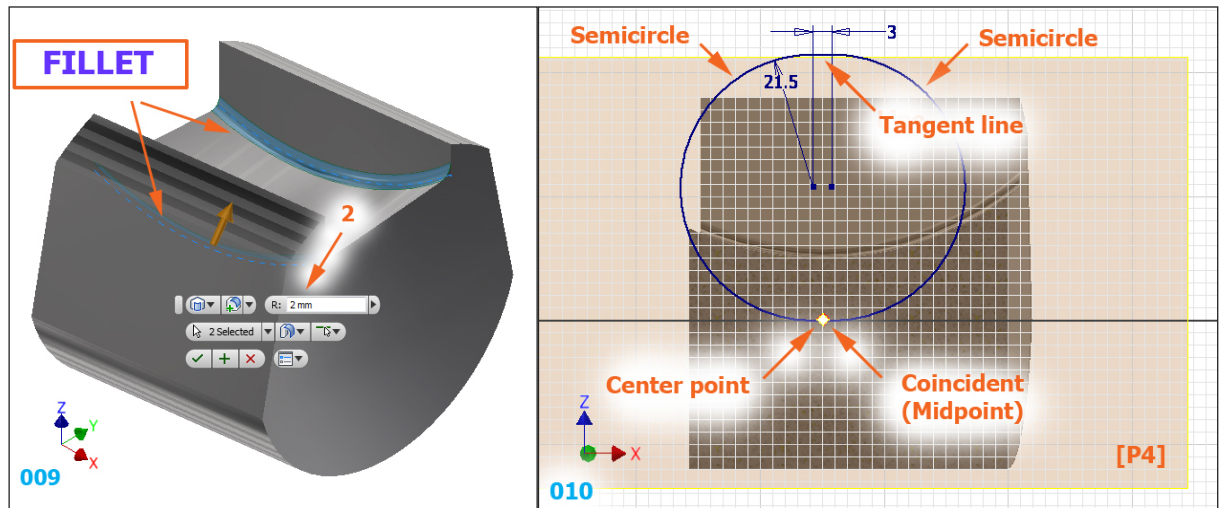

011. **Extrude** the closed profile symmetrically on 31-1.88-1.88 (as an expression)

012. **Fillet** Radius 2 on the indicated edges

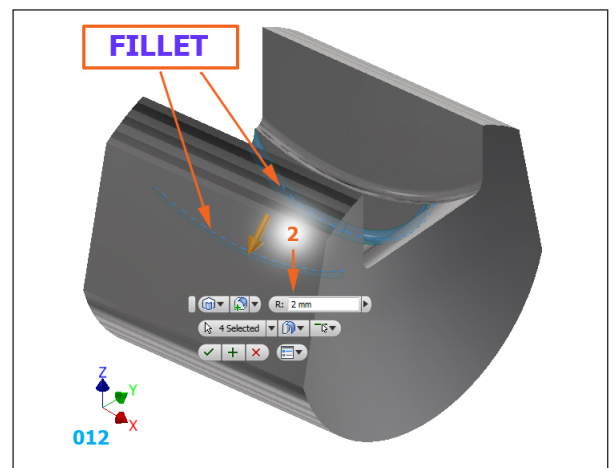
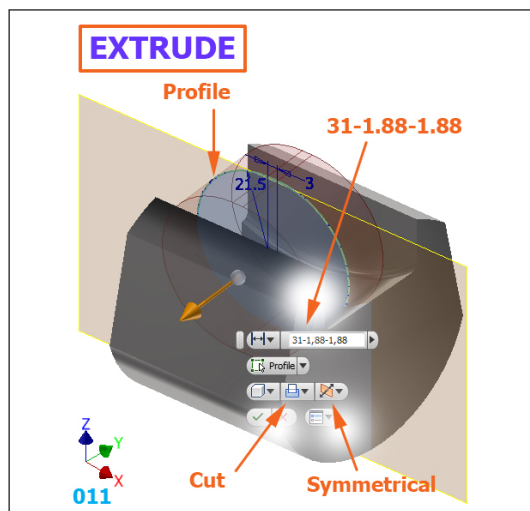

013. New sketch on *XZ Plane*: the axis (centerline) is coincident with *Center point*

014. **Revolve** the closed profile using the *Intersect* option!

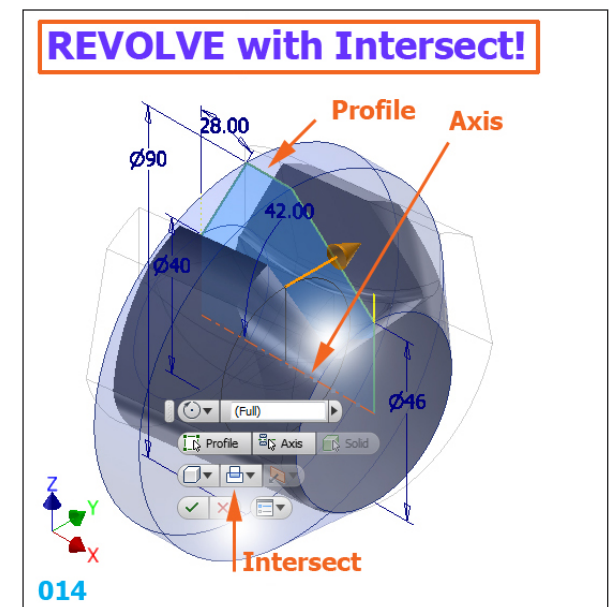
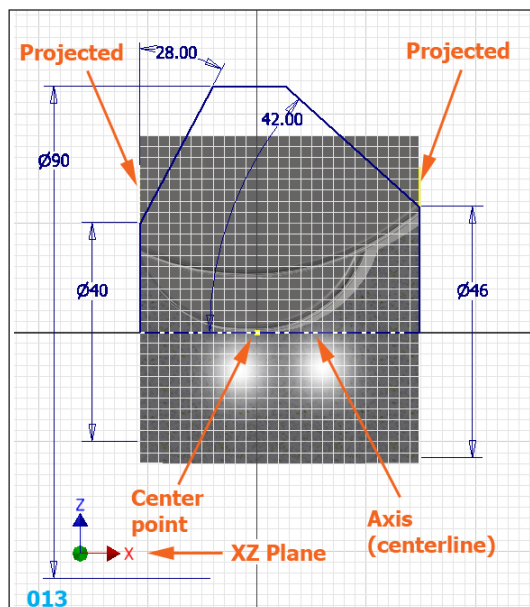

015. The middle body finished

016. **Revolve** the closed profile in a new sketch: the midpoints on the same vertical with *Center point*

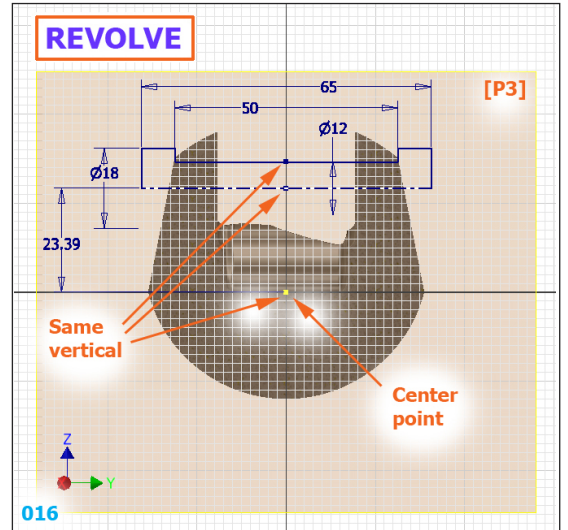
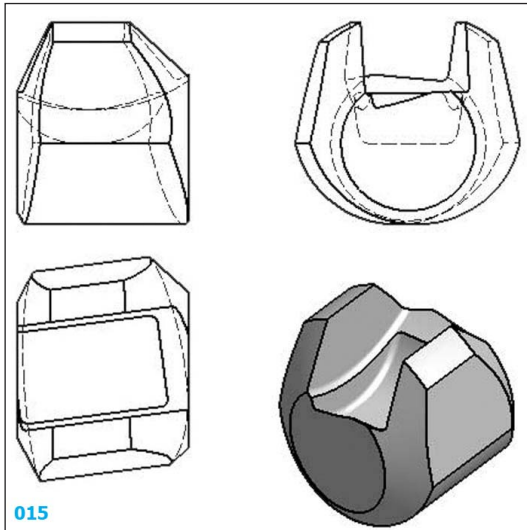

017. The result of revolving with *Cut* option

018. **Revolve** the ends of part with *Join* option using two closed profiles in a new sketch

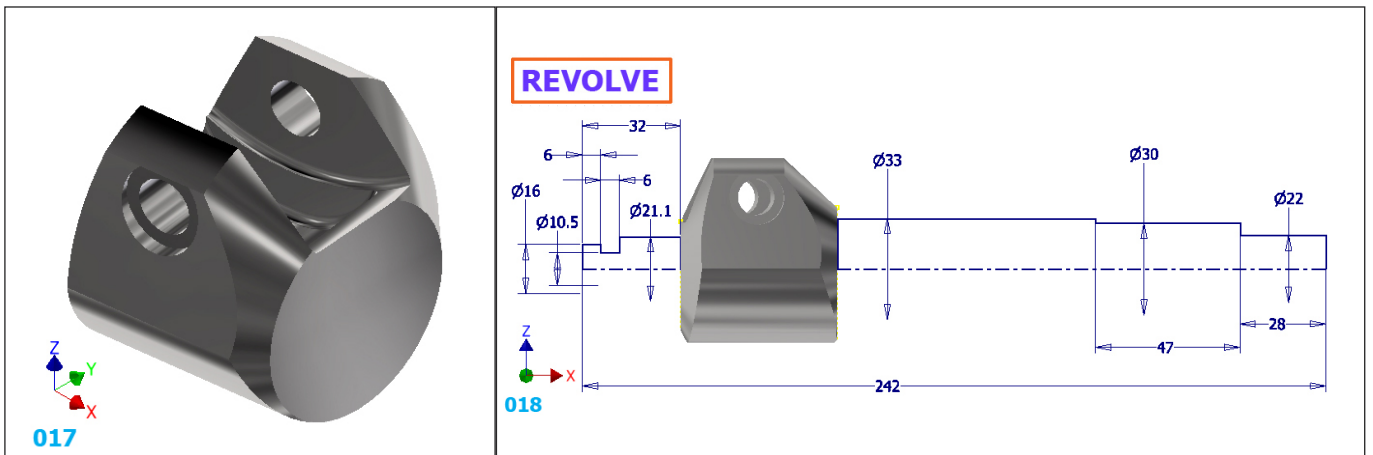

019. The result of revolving the two closed profiles

020. **Fillet** four edges with different radii

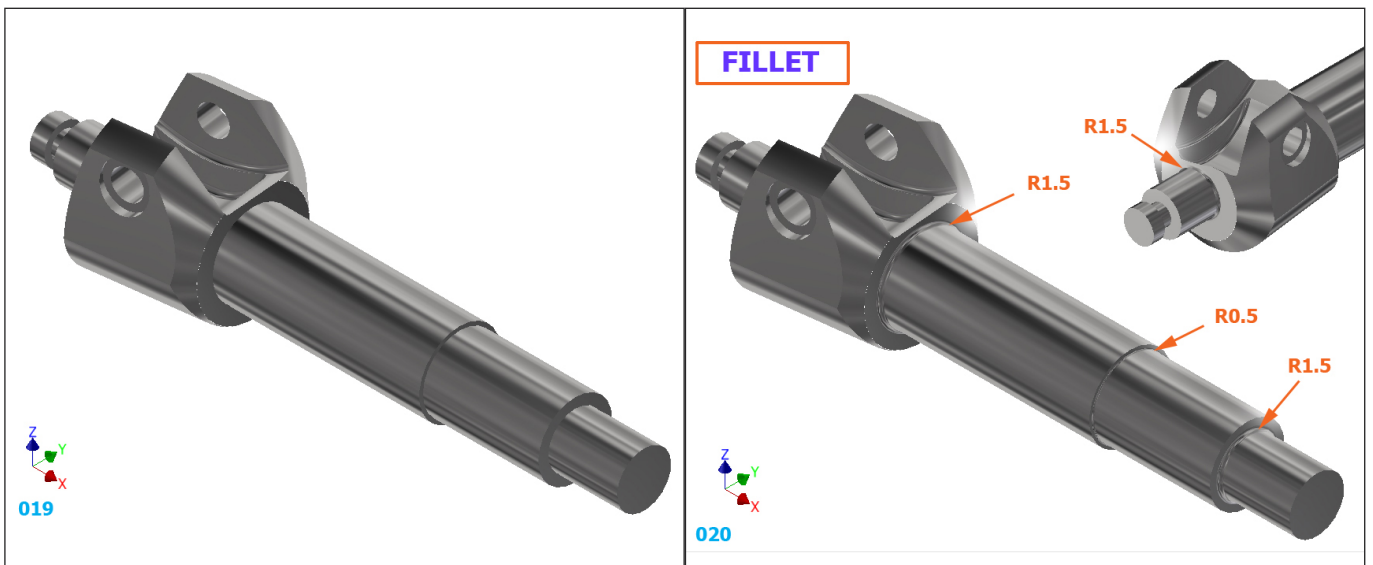

021. **Thread** the right end using the specification *ISO Metric profile / M22x3*

022. **Chamfer** five edges with different values

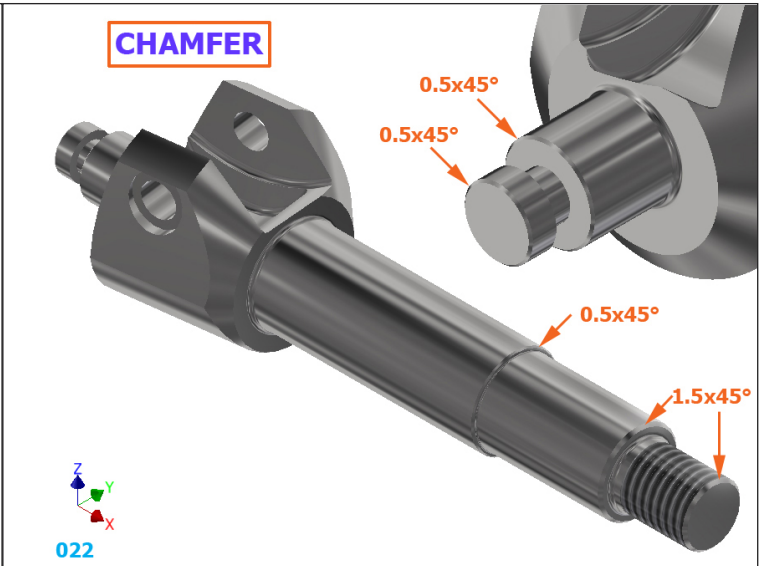
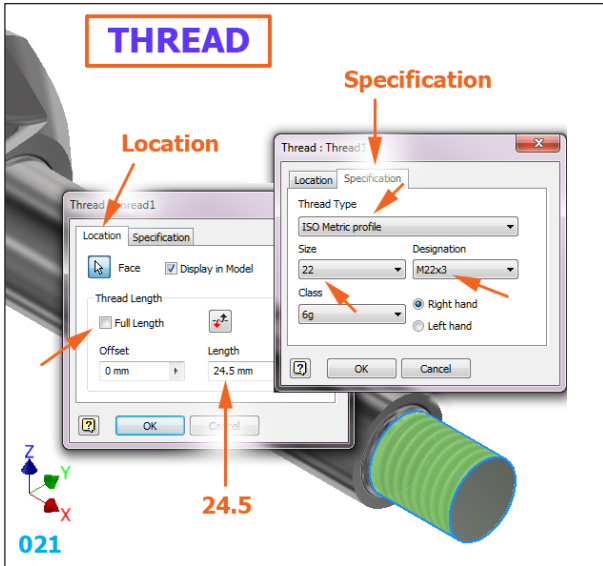

023. **Hole** on the right end of part using concentric option to obtain a countersunk hole at 60° (Ø3)

024. **Hole** on the left end of part using concentric option to obtain a countersunk hole at 60° (Ø6)

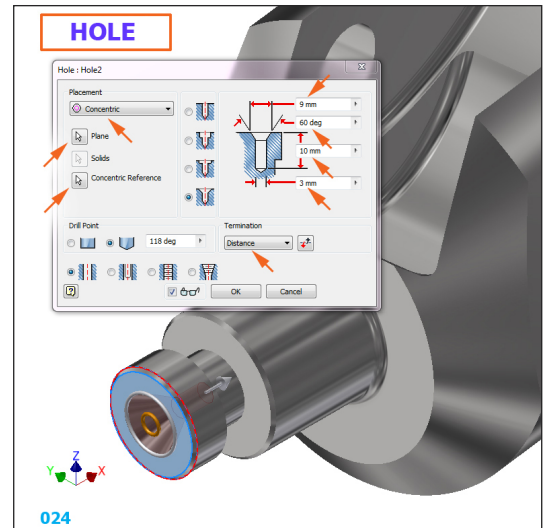
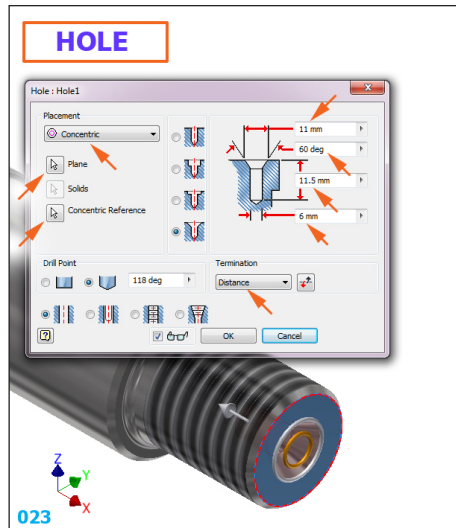

025. Preparing for creating a sketch in two steps: 1. Click on face, 2. Select „Create Sketch“ icon

026. The sketch contains a pseudo triangle at 60° with a filleted peak of 0.3 at 13.5 from Center point

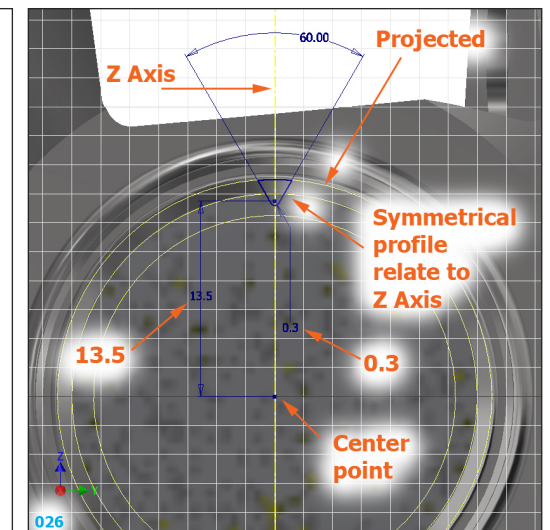
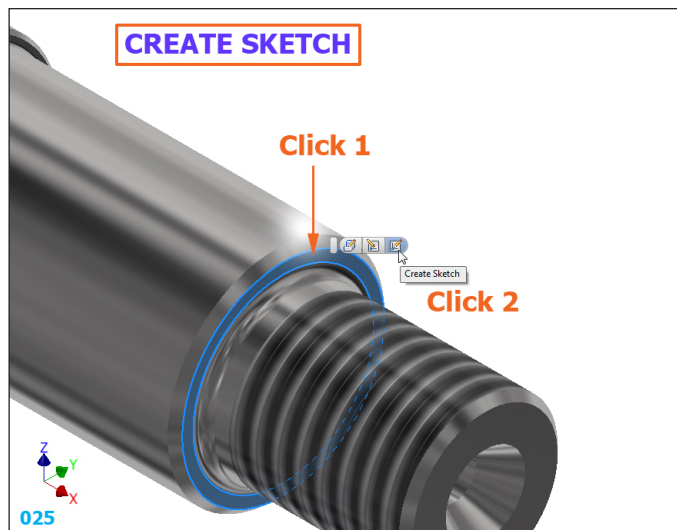

027. **Extrude** the „triangle” on a distance of 28, using option *Cut*

028. Start creating a sketch in two steps: 1. Click on face, 2. Select „Create Sketch” icon

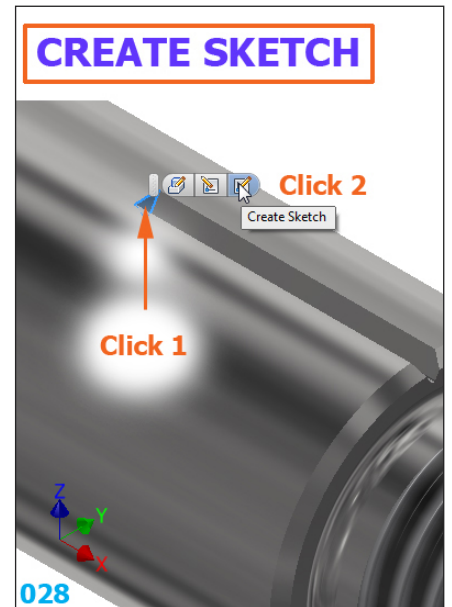
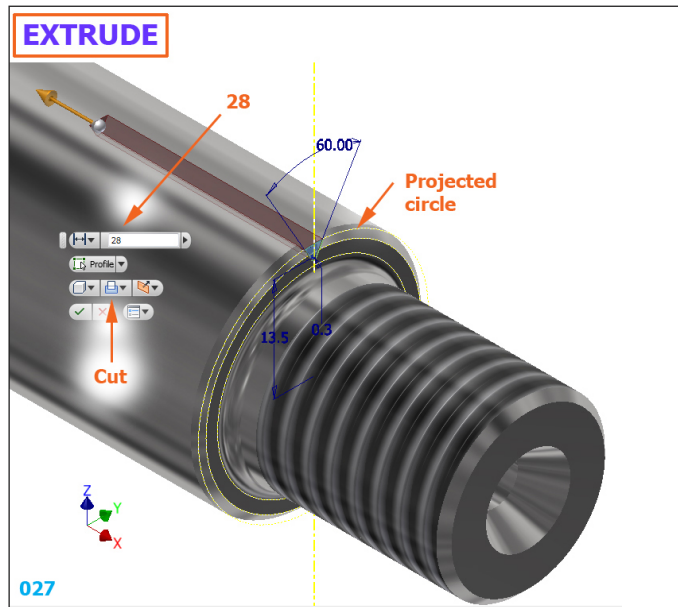

029. The sketch contains the projected „triangle” and a centerline (as Axis) at 53 from *Center point*

030. **Revolve** the „triangle” around the Axis using the option *Cut*

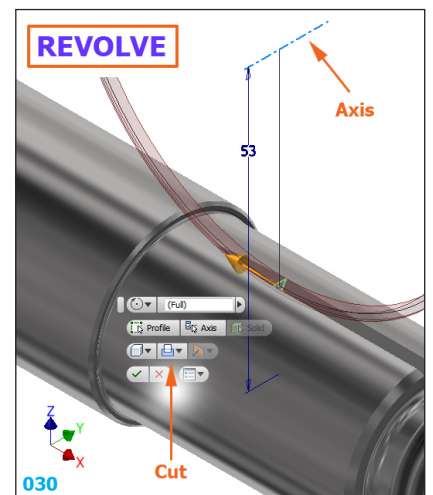
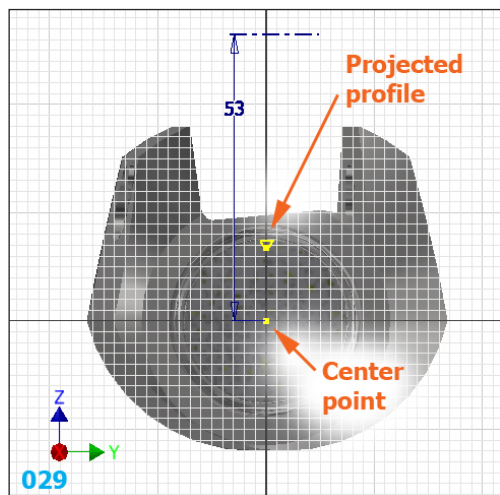

031. Apply Circular Pattern to last two features around the part axis for 35 times

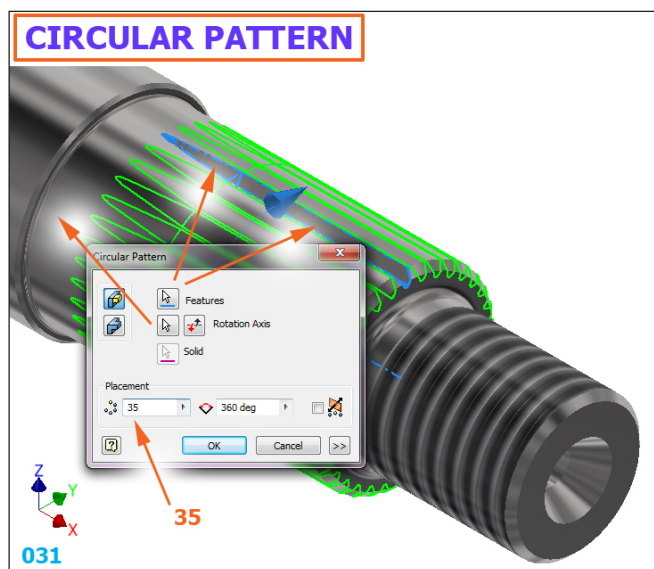

032. Create an *work axis* using a procedure in 4 steps, starting with right-click on empty graphic space

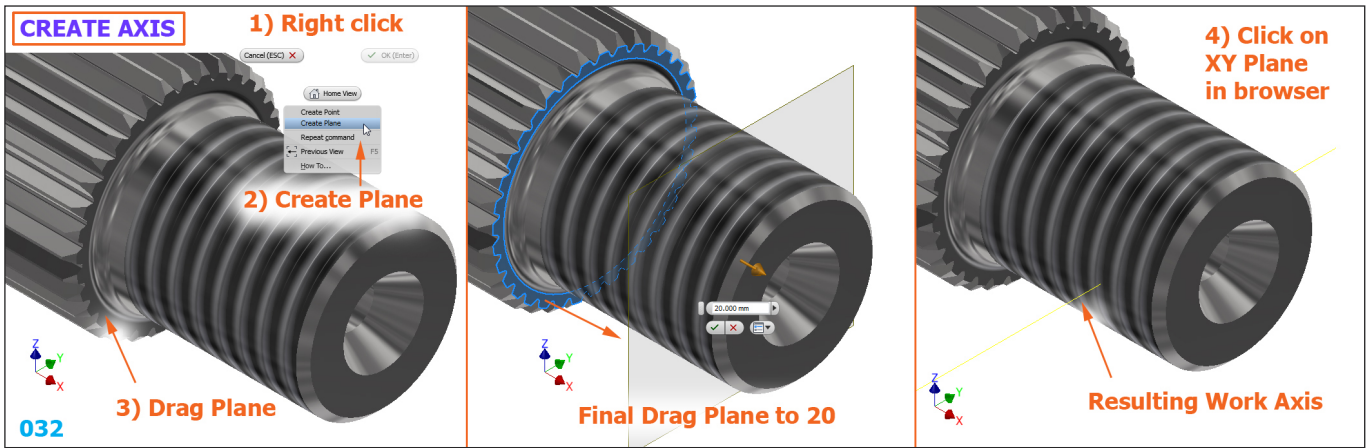

033. Create an *work point* by clicking successively on a face (1) and the axis (2)

034. Create **HOLE** with the option *On point* by selecting the point and the axis, in this order

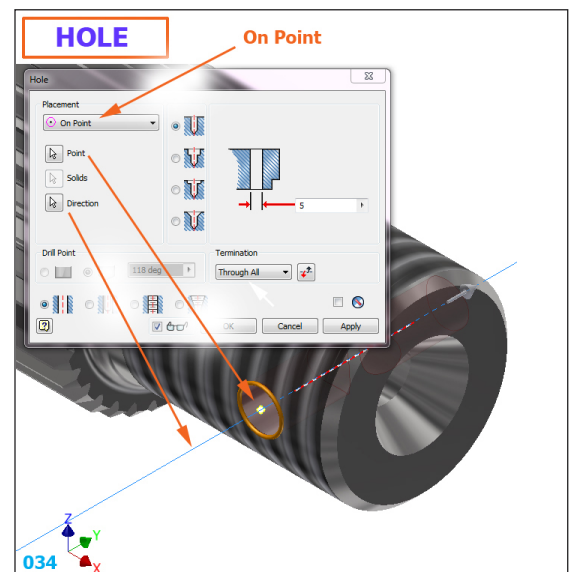
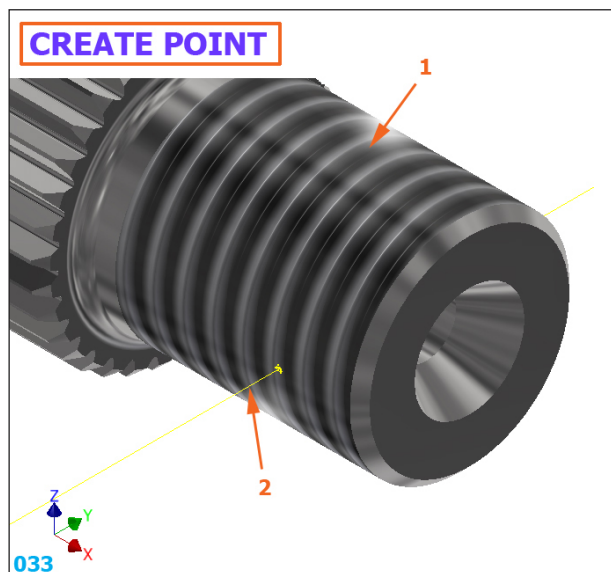

035. Final part



End of lesson

